



# Operating Room Cleaning Program



## INNOVATIVE CART SYSTEMS

- Co-polymer material resists mold, mildew, bacteria
- 30% quieter than metal
- Four pull-out drawers
- Lockable for security

## MICROFIBER MOPPING OPTIONS

- Mobile, on-demand charging of mops
- Double-bucket wringing
- Use disposable or washable mops

## OR EVS TOOLS

- Uniquely engineered for operating rooms
- Easily disinfected; resist mold, mildew, bacteria

## DISPOSABLES

- Disposable mop heads; 100% microfiber
- Dry disposable wipes; choose soaking solution
- Dry disposable dusting sleeves
- Disposable liquid absorbent pads

# ALPHA OR WORKSTATIONS

ALPHA OR WORKSTATIONS ARE AVAILABLE WITH OR WITHOUT LOCKING CABINET DOORS AND WITH EITHER EQUODOSE® ON-DEMAND MOBILE CHARGING SYSTEMS OR DOUBLE BUCKET SIDE PRESS MOPPING SYSTEM.



## COMPACT, EASY TO MANEUVER

Ideal for smaller hallways and constricted size areas. Quiet, 5-inch wheels deliver stability and maneuverability.

## FOUR DRAWERS, LOCKABLE FOR SECURITY

Easy to organize OR cleaning kits, multi-color coded liners and other supplies. Workstations available with lockable top storage area and lockable cabinet door. Top slide-out drawer is lockable, as well.

## HIGH RETURN ON INVESTMENT

Workstations have a life-cycle of 6 - 10 years. Individual components are easily replaced or repaired.

## EASILY DISINFECTED

Co-polymer material is easily cleaned & disinfected; curved corners reduces build-up of debris. Material will not rust and resists mold, mildew and bacteria.



CART FOR DISPOSABLE STRING MOP

CART FOR FLAT MOP (DISPOSABLE AND REUSABLE)



Lockable w/Double Bucket  
39"L x 29" W x 44"H



Open w/Double Bucket  
39"L x 29" W x 42"H



Lockable w/Equodose®  
46"L x 22" W x 44"H



Open w/Equodose®  
46"L x 22" W x 44"H



# OR CLEANING EQUIPMENT

## LINEN / WASTE MANAGEMENT



## DELTA LINEN / WASTE COLLECTION



## SURFACE / FLOOR CLEANING



## ERGO BAGGY SQUEEGEE COLLECTION PAN



## MONO-WIPE TNT50 DRY DISPOSABLE CLOTH-WIPES



## DRY-UP DISPOSABLE LIQUID ABSORBENT PAD



## MICROFIBER CLOTHS COLOR-CODED

## HIGH-REACH CLEANING/DUSTING



## SPILLO FLEX SPINE WET DUSTING SYSTEM

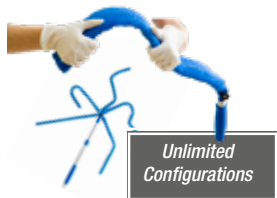

## SNAKE BEND SPINE DRY DUSTING SYSTEM



Use with Quik-Stik Disposable Sleeve



Use with two  
MONO-WIPE  
Disposable  
Wipes



1 Lay Spillo on top of two (2) Mono-Wipes



2 Fold top of Mono-Wipe over Spillo



3 Fold over one side



4 Fold second side over

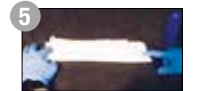

5 Secure by pushing Mono-Wipe into Spillo star keepers

# DISPOSABLES EQUIPMENT

## DISPOSABLES FOR OPERATING ROOMS



### MONO-WIPE TNT50 DRY DISPOSABLE CLOTH-WIPES



#### HAND-WIPE



#### SPILLO FLEX SPINE



**ERGO BAGGY FLOOR COLLECTION** with DISPOSABLE BAG



**DRY-UP DISPOSABLE LIQUID ABSORBING PAD**



**DISPOSABLE STRING MOP**



**MONO-MICRO PE100 18.5" 100% MICROFIBER DISPOSABLE MOPS**



**QUIK-STIK DISPOSABLE DUSTING SLEEVE**

## MOP CHARGING SYSTEMS

### EQUODOSE<sup>®</sup> ON-DEMAND MOBILE MICROFIBER CHARGING SYSTEM



**PATENTED**



#### ON-DEMAND, RAPID SINGLE MICROFIBER MOP CHARGING

- Charge mops and/or cleaning cloths as needed
- Set desired saturation amount: 2 oz. to 12 oz.
- Eliminates transport of heavy mop buckets
- No chance of bucket spillage

#### CONSERVE RESOURCES

- Refillable, sealed tanks don't waste chemicals
- Easy re-stocking of unused mops & cloths
- Less weight to carry = decreased worker strain

### ALPHA ON-BOARD DOUBLE BUCKET SYSTEM



*Separate buckets lay flat on cart platform to eliminate tipping or movement.*

#### SEPARATE BUCKETS SIMPLIFY USAGE

One bucket used for cleaning solution; the other holds clean, dry disposable string mops.

#### MAXIMUM STABILITY STRUCTURE

Firmly holds buckets in place during transport and use.



*2-4 gallon buckets*

# MOPPING OPTIONS

## FILMOP FLAT MOPPING SYSTEMS: THE PREFERRED CHOICE OF EVS



- Articulated joint enables 360° performance for easy cleaning on all surfaces
- Patented locking system holds mop in place for cleaning walls, ceilings & floors



- The pocket mop holder locking system is foot operated — no touch!
- Better mopping performance as flat mops retain full, consistent contact with surface



holder weighs just 1.17 lbs.

- Mop holders are made of closed cell, recyclable, light-weight co-polymer material
- Resists mold, mildew, bacteria. Easy to clean and disinfect.

### PRESS•CONNECT SYSTEM

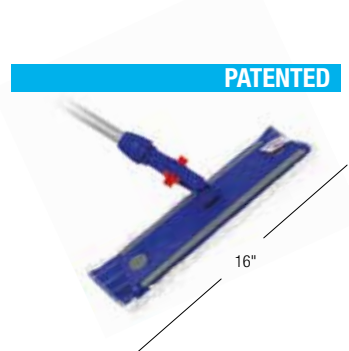

**NO FOAM CONSTRUCTION**

**REPLACEABLE PRESS•CONNECT STRIPS**



**MONO-MICRO PE100**  
18.5" 100% MICROFIBER  
DISPOSABLE MOPS

**MICRO-KLEEN**  
MICROFIBER  
LONG-LOOP MOPS

**EQUODOSE CHARGING**

### POCKET MOP SYSTEM

Uniko®

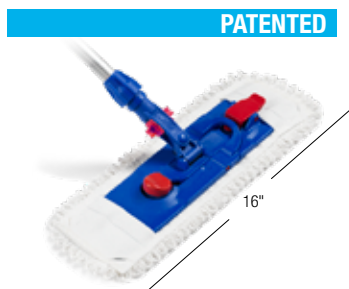

**NO-TOUCH MECHANISM**

**NO VELCRO, NO FOAM**



**MICRO-KLEEN** MICROFIBER  
LONG-LOOP MOPS

**EQUODOSE CHARGING**

### DISPOSABLE STRING MOP



**CO-POLYMER HOLDER**

**ABSORBS UP TO 5 TIMES ITS WEIGHT**

**LOW LINT, LATEX-FREE**

**WRING MOP SYSTEM**



PRODUCT (S)	ITEM #	DESCRIPTION	Unit of Measure	Case Pack
	0000SM00633	ALL WORKSTATIONS INCLUDE: ONE (1) KEY MANAGEMENT SYSTEM (Includes 1 lanyard, 1 retractable key ring, 3 standard Universal locking keys without tabs)		
	0000SM00250U	ALL WORKSTATIONS INCLUDE: FOUR (4) UNI-MOVE UNIVERSAL HANDLE HOLDER		
	AA3607417U001	<b>OR ALPHA WORKSTATION 39 LOCKABLE COMPLETE WITH ON BOARD DOUBLE BUCKET &amp; SIDE PRESS (ASSEMBLED)</b> DOUBLE BUCKET: TWO (2) 6.5 GALLON BUCKETS. HANGING BAR INSTALLED FOR HANGING TOOLS WITH UNI-MOVE. TOWER CONTENT: - ONE (1) LOCKABLE SLIDING DRAWER 6 gallon with organizer - THREE (3) SLIDING DRAWERS - 6 gallon each - FOUR (4) 5-INCH SWIVEL WHEELS - ONE (1) ALPHA ES WORKSTATION EASY ACCESSORY HANGING KIT	case	1
	AA0507416U002	<b>OR ALPHA WORKSTATION 39 OPEN COMPLETE WITH ON BOARD DOUBLE BUCKET &amp; SIDE PRESS (ASSEMBLED)</b> DOUBLE BUCKET: TWO (2) 6.5 GALLON BUCKETS TOWER CONTENT: - ONE (1) LOCKABLE SLIDING DRAWER 6 gallon with organizer - THREE (3) SLIDING DRAWERS - 6 gallon each - FOUR (4) 5-INCH SWIVEL WHEELS - ONE (1) ALPHA ES WORKSTATION EASY ACCESSORY HANGING KIT	case	1
	AA3607710U002	<b>OR ALPHA WORKSTATION 46 LOCKABLE COMPLETE WITH SINGLE-TANK EQUODOSE® SYSTEM (ASSEMBLED)</b> HANGING BAR INSTALLED FOR HANGING TOOLS WITH UNI-MOVE. TOWER CONTENT: - ONE (1) LOCKABLE SLIDING DRAWER 6 gallon with organizer - THREE (3) SLIDING DRAWERS - 6 gallon each - FOUR (4) 5-INCH SWIVEL WHEELS - ONE (1) ALPHA ES WORKSTATION EASY ACCESSORY HANGING KIT - ONE (1) SIDE BASKET FOR RED BUCKET - 5 gallon - ONE (1) BLUE BUCKET - 5 gallon	one	1
	AA0507712U001	<b>OR ALPHA WORKSTATION 46 OPEN COMPLETE WITH ON BOARD DOUBLE BUCKET &amp; SIDE PRESS (ASSEMBLED)</b> TOWER CONTENT: - ONE (1) LOCKABLE SLIDING DRAWER 6 gallon with organizer - THREE (3) SLIDING DRAWERS - 6 gallon each - FOUR (4) 5-INCH SWIVEL WHEELS - ONE (1) ALPHA ES WORKSTATION EASY ACCESSORY HANGING KIT - ONE (1) SIDE BASKET FOR RED BUCKET - 5 gallon - ONE (1) BLUE BUCKET - 5 gallon	case	1
	5359A	<b>16" PRESS•CONNECT SYSTEM MOP HOLDER, BLUE, W/LOCKING CONNECTOR</b>	case	10
	0000TA0346A	<b>18" ALUMINUM PRESS•CONNECT MOP HOLDER, W/ LOCKING CONNECTOR</b>	case	10
	0001PN02142	<b>18.5" FILMOP MONO-MICRO PE100, DISPOSABLE MOP, 100% PE MICROFIBER (0.5 Denier) ON BOTH SIDES, 4-5 oz CHEMICAL ABSORBANCY, WHITE, 18.5" X 5.5", PRESS•CONNECT SYSTEM. 1 BAG = 50 MOPS; MIN ORDER: 1 CASE/10 bags/500 MOPS (1 bag = 50 MOPS), multiples of cases only.</b>	case	1
	0000PN03025A	<b>17.5" MICRO-KLEEN MICROFIBER TWIST LOOP MOP PRESS•CONNECT SYSTEM, BLUE, 4.3 oz, 300 WASHINGS</b>	case	100
	0001TD0320AB	<b>16" UNIKO® POCKET SYSTEM MOP HOLDER, BLUE, W/CLIP AND LOCKING CONNECTOR</b>	case	10
	0000PN04025D	<b>18" MICRO-KLEEN MICROFIBER TWIST LOOP MOP POCKET SYSTEM, WHITE-GRAY, 4.5 oz, 4 COLOR TAGS, 300 WASHINGS</b>	case	100
	6020u/1-10	<b>6" STRING MOP HOLDER LARGE, GRAY</b>	case	10
	6201D	<b>9 oz. DISPOSABLE STRING MOP, WHITE. 16" STRANDS OF POLYESTER/CELLULOSE. ABSORBS UP TO 5X ITS WEIGHT.</b>	case	50
	refer to cover color item numbers in description box	<b>DELTA COLLECTION FRAME KIT: WHITE CO-POLYMER FRAME WITH 4 SWIVEL WHEELS, FOOT PEDAL AND CHOICE OF COVER COLOR. TWO STATIONARY FRONT FEET INCLUDED FOR OPTIONAL USE.</b> 0000CO4120U gray ● 0000CO4121U blue ● 0000CO4122U red ● 0000CO4123U yellow ● 0000CO4124U green ●	case	2
	00PU0203000	<b>11" x 12.5" MONO-WIPE TNT50 DISPOSABLE CLOTH-WIPES, NON-WOVEN, 65% RAYON / 35% POLYESTER. 1 ROLL, PULLS FROM THE CENTER. (6 rolls / case. 90 wipes per roll = 540 wipes per case). Roll size: 7.87"x 5.3 x 5.5" (wipes are folded in half for packaging).</b>	case	1
	0000SE3104A	<b>1 gallon REUSABLE DISPOSABLE WIPE DISPENSER (FOR CHARGING OR DISPENSING DISPOSABLE WIPES), BLUE. HEAVY-DUTY CO-POLYMER WITH SLIDE-N-SEAL DISPENSING OPENING.</b>	case	10
	refer to color item numbers in description box	<b>12" x 12" COLOR CODED MICROFIBER CLEANING CLOTHS. 200 WASHINGS.</b> A0052-200 blue ● A0072-200 red ● A0082-200 yellow ● A0062-200 green ●	case	200
	1650A02	<b>24" SNAKE BEND SPINE DUSTING KIT: 24" SNAKE FRAME, BLUE (ITEM# 1650A); POLE ADAPTOR FOR ATTACHMENT TO POLE (ITEM# P179041A); 38" - 72" ALUMINUM TELESCOPIC POLE (ITEM# 0000AM3070UA).</b>	case	6
	00PU0102000	<b>24" QUIK-STIK DISPOSABLE DUSTING SLEEVE, WHITE</b>	case	10
	1460U02	<b>16" SPILLO FLEX SPINE DUSTER KIT: 16" SPILLO FRAME, BLUE (ITEM# 1460A); POLE ADAPTOR FOR ATTACHMENT TO POLE (ITEM# P179041A); 38" - 72" ALUMINUM TELESCOPIC POLE (ITEM# 0000AM3070UA).</b>	case	6
	00PU0203000	<b>11" x 12.5" MONO-WIPE TNT50 DISPOSABLE WIPES, NON-WOVEN, 65% RAYON / 35% POLYESTER. 1 ROLL, CENTER PULL</b>	case	1
	0000PN02069-200	<b>17.75" x 13" DRY UP PADS DISPOSABLE, 0.25 gal ABSORBANCY. FREE SHIPPING !</b>	case	200
	0000PA20400	<b>ERGO BAGGY COLLECTION SYSTEM W/DISPOSABLE BAG, COMPLETE (Bag Holder, Squeegees, 10 bags)</b>	case	6