



Product Catalog

Packaging Choice and Sustainability

Brand Profile



At Duro™ Bag, we know that a lot goes into creating your brand. A Duro Bag Shopping Bag can enhance your brand statement to its fullest potential. Duro provides all the support you need during the packaging design development, all the way through production and consumer use. You can rely on Duro for industry leading expertise and quality production capabilities to ensure your brand's creative design is well represented in your packaging.



The Duro Bag Brand Advantage

Duro Bag, a Novolex™ brand, is a premier leader in the paper bag industry – with approximately 20 billion paper bags manufactured annually for every market segment. You can trust your paper bag needs to the Duro Bag Brand from Novolex.

Our Mission

Duro Bag's mission is to be the preeminent manufacturer of paper bags through uncompromising quality, innovative solutions, customer service and satisfaction, while valuing our employees and vendors with constant attention to our impact on the environment.

Sustainability



A continuous journey of improvement

Novolex is a leader in sustainable paper and plastic flexible packaging with a broad portfolio of solutions focused on source reduction, energy and water conservation, and end of life product planning and management.

Some of the Novolex sustainability solutions we bring to our customers include: recycled content plastic and paper products, compostable plastic and paper products, renewable substrates, Novolex's Bag-2-Bag® plastic bag and film recycling program, lower impact substrates such as our EcoCraft® and Dubl Life® lines of paper products, and other industry leading innovations that minimize raw materials while maximizing performance.

Table of Contents



SOS Bags

- 4 Dubl Life® SOS Bags
- 5 Standard White SOS Bags
- 6 Husky Dubl Life® SOS Bags
- 7 Bulwark SOS Bags

Sacks

- 8 Dubl Life® 1/6, 1/7 & 1/8 BBL Sacks
- 9 1/6, 1/7 & 1/8 BBL Sacks
- 10 1/4 BBL & Satchel Bottom Sacks

Diecut Handle Bags

- 11 Die Cut Handle Bags

Liquor Bags

- 12 Liquor Bags

Merchandise Bags

- 13 Merchandise Bags

Load and Fold™ Bags

- 14 Load and Fold™ Bags

Lawn and Leaf Bags

- 15 Lawn and Leaf Bags

Shopping Bags

- 16 Dubl Life® Shopping Bags
- 17 Shopping Bags

Sustainability Partnerships 18

SOS Bags



Dubl Life® SOS Bags

100% Recycled Kraft

Performance Features

- Made from 100% Recycled Paper
- Bags are FSC® chain of custody certified
- Self opening style (SOS) bags are an ideal choice for retail, foodservice and grocery stores

Custom
printing
available



| Item# | UPC | Bag Size | Dimensions | Basis Weight | Bale Pack | Pack Config. | Bales/Pallet | Ti/Hi | Bale Weight (lbs.) | Bale Dimensions L x W x H | Cubic | Load Dimensions |
|-------|--------------|----------|---------------------------|--------------|-----------|--------------|--------------|---------|--------------------|---------------------------|-------|--------------------|
| 18450 | 079594184502 | 1/2 # | 3 x 1 7/8 x 5 7/8 | 30# | 4M | 8/500 | 56 | 8 x 7 | 20 | 16.5 x 12.25 x 6.5 | 0.76 | 51 x 38.5 x 48 |
| 18401 | 079594184014 | 1# | 3 1/2 x 2 3/8 x 6 7/8 | 30# | 4M | 8/500 | 36 | 6 x 6 | 28.6 | 18.5 x 13.25 x 7.25 | 1.03 | 44 x 38.5 x 47.5 |
| 18402 | 079594184021 | 2# | 4 3/16 x 2 7/16 x 7 7/8 | 30# | 500 | 1/500 | 200 | 20 x 10 | 4.8 | 8.25 x 10.5 x 4 | 0.20 | 43 x 41.5 x 50 |
| 18403 | 079594184038 | 3# | 4 3/4 x 2 13/16 x 8 5/16 | 30# | 500 | 1/500 | 180 | 20 x 9 | 6.1 | 9 x 10.25 x 4.75 | 0.25 | 43 x 36.5 x 48 |
| 18404 | 079594184045 | 4# | 5 x 3 1/8 x 9 3/4 | 30# | 500 | 1/500 | 128 | 16 x 8 | 7.1 | 10 x 10.25 x 5.25 | 0.31 | 43 x 41.5 x 46 |
| 18405 | 079594184052 | 5# | 5 1/4 x 3 1/16 x 10 15/16 | 35# | 500 | 1/500 | 96 | 12 x 8 | 9.8 | 11 x 11 x 5.5 | 0.39 | 46 x 34 x 47.5 |
| 18406 | 079594184069 | 6# | 6 x 3 3/8 x 11 1/16 | 35# | 500 | 1/500 | 84 | 12 x 7 | 10 | 11.5 x 11.5 x 6 | 0.46 | 47 x 35 x 48 |
| 18408 | 079594184083 | 8# | 6 1/8 x 4 1/8 x 12 1/16 | 35# | 500 | 1/500 | 84 | 12 x 7 | 12 | 13 x 10.5 x 6.25 | 0.49 | 44.5 x 40 x 48 |
| 18410 | 079594184106 | 10# | 6 3/16 x 4 3/16 x 13 3/8 | 35# | 500 | 1/500 | 72 | 12 x 6 | 12.7 | 13.5 x 11.5 x 6.75 | 0.61 | 44 x 41 x 44 |
| 18412 | 079594184120 | 12# | 7 1/16 x 4 1/2 x 13 3/4 | 40# | 500 | 1/500 | 60 | 10 x 6 | 17.3 | 14 x 14 x 7.25 | 0.82 | 43.5 x 40 x 47 |
| 18416 | 079594184168 | 16# | 7 3/4 x 4 13/16 x 16 | 40# | 500 | 1/500 | 45 | 9 x 5 | 21.6 | 16.25 x 13.25 x 8 | 1.00 | 44.5 x 42.5 x 44.5 |
| 18420 | 079594184205 | 20# | 8 1/4 x 5 3/16 x 16 1/8 | 40# | 500 | 1/500 | 45 | 9 x 5 | 25.3 | 16.5 x 13 x 8.5 | 1.06 | 50.5 x 40 x 46.5 |
| 18421 | 079594184212 | 20# SH | 8 1/4 x 5 15/16 x 13 3/8 | 40# | 500 | 1/500 | 45 | 9 x 5 | 24.2 | 14.5 x 13.75 x 8.5 | 0.98 | 43.5 x 44.5 x 46.5 |
| 18424 | 079594184243 | 25# | 8 1/4 x 5 1/4 x 18 | 40# | 500 | 1/500 | 40 | 8 x 5 | 25.7 | 18.5 x 11.5 x 8.5 | 1.05 | 47.5 x 37.5 x 46.5 |
| 18428 | 079594184281 | 25# SH | 8 1/4 x 6 1/8 x 15 7/8 | 40# | 500 | 1/500 | 45 | 9 x 5 | 24.7 | 15.5 x 12.5 x 8.5 | 0.95 | 47.5 x 40 x 46.5 |

Standard White SOS Bags

White 40% Recycled Paper and White Virgin Paper
Performance Features

- Duro™ Bag Sacks have been a standard across the nation for decades
- Sturdy, large capacity bags
- 40% recycled sustainable option
- Available in Plain or Custom Print



White 40% Recycled Paper

| Item# | UPC | Bag Size | Dimensions | Basis Weight | Bale Pack | Pack Config. | Bales/Pallet | Ti/Hi | Bale Weight (lbs.) | Bale Dimensions L x W x H | Cubic | Load Dimensions |
|-------|--------------|----------|--------------------------|--------------|-----------|--------------|--------------|-------|--------------------|---------------------------|-------|------------------|
| 14030 | 079594140300 | 2# | 4 3/16 x 2 7/16 x 7 7/8 | 30# | 500 | 1/500 | 200 | 20x10 | 4.9 | 8.25 x 8 x 4 | 0.15 | 41 x 40 x 50 |
| 14032 | 079594140324 | 4# | 5 x 3 1/8 x 9 3/4 | 30# | 500 | 1/500 | 128 | 16x8 | 7 | 10 x 9.5 x 5.25 | 0.29 | 42 x 40.5 x 46 |
| 14034 | 079594140348 | 6# | 6 x 3 3/8 x 11 1/16 | 35# | 500 | 1/500 | 84 | 12x7 | 11.1 | 11.5 x 11 x 6 | 0.44 | 44 x 35 x 48 |
| 14035 | 079594140355 | 8# | 6 1/8 x 4 1/8 x 12 7/16 | 35# | 500 | 1/500 | 84 | 12x7 | 13.2 | 13 x 10.25 x 6.25 | 0.48 | 44.5 x 40 x 48 |
| 14036 | 079594140362 | 10# | 6 5/16 x 4 3/16 x 13 3/8 | 35# | 500 | 1/500 | 72 | 12x6 | 13.5 | 13.5 x 10.5 x 6.75 | 0.55 | 42 x 43 x 44 |
| 14037 | 079594140379 | 12# | 7 1/16 x 4 1/2 x 13 3/4 | 40# | 500 | 1/500 | 60 | 10x6 | 17.5 | 14 x 11 x 7.25 | 0.65 | 43 x 31 x 47 |
| 14038 | 079594140386 | 16# | 7 3/4 x 4 13/16 x 16 | 40# | 500 | 1/500 | 45 | 9x5 | 23.2 | 16.25 x 11.5 x 8 | 0.87 | 50 x 37.5 x 44.5 |
| 14039 | 079594140393 | 20# | 8 1/4 x 5 3/16 x 16 1/8 | 40# | 500 | 1/500 | 45 | 9x5 | 24.2 | 16.5 x 10.5 x 8.5 | 0.85 | 50 x 34 x 46.5 |
| 14040 | 079594140409 | 20# SH | 8 1/4 x 5 13/16 x 13 3/8 | 40# | 500 | 1/500 | 45 | 9x5 | 25.2 | 14.5 x 12.5 x 8.5 | 0.89 | 44 x 40 x 46.5 |
| 14041 | 079594140416 | 25# | 8 1/4 x 5 1/4 x 18 | 40# | 500 | 1/500 | 40 | 8x5 | 25.9 | 18.5 x 10.25 x 8.5 | 0.93 | 44.5 x 38 x 46.5 |

White Virgin Paper

| Item# | UPC | Bag Size | Dimensions | Basis Weight | Bale Pack | Pack Config. | Bales/Pallet | Ti/Hi | Bale Weight (lbs.) | Bale Dimensions L x W x H | Cubic | Load Dimensions |
|-------|--------------|----------|---------------------------|--------------|-----------|--------------|--------------|---------|--------------------|---------------------------|-------|--------------------|
| 51001 | 079594510011 | 1# | 3 1/2 x 2 3/8 x 6 7/8 | 30# | 4M | 8/500 | 36 | 6 x 6 | 29.3 | 18.5 x 13 x 7.25 | 1.01 | 41 x 38 x 47.5 |
| 51002 | 079594510028 | 2# | 4 3/16 x 2 7/16 x 7 7/8 | 30# | 500 | 1/500 | 200 | 20 x 10 | 4.9 | 8.25 x 8 x 4 | 0.15 | 41 x 40 x 50 |
| 51003 | 079594510035 | 3# | 4 3/4 x 2 13/16 x 8 5/16 | 30# | 500 | 1/500 | 180 | 20 x 9 | 6.1 | 9 x 10.25 x 4.75 | 0.25 | 43 x 36.5 x 48 |
| 51004 | 079594510042 | 4# | 5 x 3 1/8 x 9 3/4 | 30# | 500 | 1/500 | 128 | 16 x 8 | 7 | 10 x 9.5 x 5.25 | 0.29 | 42 x 40.5 x 46 |
| 51045 | 079594510455 | 5# | 5 1/4 x 3 7/16 x 10 13/16 | 35# | 500 | 1/500 | 96 | 12 x 8 | 10 | 11 x 10.75 x 5.5 | 0.38 | 43.5 x 34.5 x 47.5 |
| 51046 | 079594510462 | 6# | 6 x 3 3/8 x 11 1/16 | 35# | 500 | 1/500 | 84 | 12 x 7 | 11.1 | 11.5 x 11 x 6 | 0.44 | 44 x 35 x 48 |
| 51028 | 079594510288 | 8# | 6 1/8 x 4 1/8 x 12 7/16 | 35# | 500 | 1/500 | 84 | 12 x 7 | 13.2 | 13 x 10.25 x 6.25 | 0.48 | 44.5 x 40 x 48 |
| 51030 | 079594510301 | 10# | 6 5/16 x 4 3/16 x 13 3/8 | 35# | 500 | 1/500 | 72 | 12 x 6 | 13.5 | 13.5 x 10.5 x 6.75 | 0.55 | 42 x 43 x 44 |
| 51032 | 079594510325 | 12# | 7 1/16 x 4 1/2 x 13 3/4 | 40# | 500 | 1/500 | 60 | 10 x 6 | 17.5 | 14 x 11 x 7.25 | 0.65 | 43 x 31 x 47 |
| 51036 | 079594510363 | 16# | 7 3/4 x 4 13/16 x 16 | 40# | 500 | 1/500 | 45 | 9 x 5 | 23.2 | 16.25 x 11.5 x 8 | 0.87 | 50 x 37.5 x 44.5 |
| 51040 | 079594510400 | 20# | 8 1/4 x 5 3/16 x 16 1/8 | 40# | 500 | 1/500 | 45 | 9 x 5 | 24.2 | 16.5 x 10.5 x 8.5 | 0.85 | 50 x 34 x 46.5 |
| 51041 | 079594510417 | 20# SH | 8 1/4 x 5 13/16 x 13 3/8 | 40# | 500 | 1/500 | 45 | 9 x 5 | 25.2 | 14.5 x 12.5 x 8.5 | 0.89 | 44 x 40 x 46.5 |
| 51025 | 079594510257 | 25# | 8 1/4 x 5 1/4 x 18 | 40# | 500 | 1/500 | 40 | 8 x 5 | 25.9 | 18.5 x 10.25 x 8.5 | 0.93 | 44.5 x 38 x 46.5 |
| 51026 | 079594510264 | 25# SH | 8 1/4 x 6 1/8 x 15 7/8 | 40# | 500 | 1/500 | 45 | 9 x 5 | 24.7 | 15.5 x 11.5 x 8.5 | 0.88 | 47 x 37.5 x 46.5 |

SOS Bags



Husky Dubl Life® SOS Bags

100% Recycled Kraft
Performance Features

- Made from 100% Recycled Paper
- Bags are FSC® chain of custody certified
- Heavy duty self opening style (SOS) bags for the most demanding applications

Custom
printing
available



| Item# | UPC | Bag Size | Dimensions | Basis Weight | Bale Pack | Pack Config. | Bales/Pallet | Ti/Hi | Bale Weight (lbs.) | Bale Dimensions L x W x H | Cubic | Load Dimensions |
|-------|--------------|----------|---------------------------|--------------|-----------|--------------|--------------|-------|--------------------|---------------------------|-------|----------------------|
| 70202 | 079594702027 | 2# | 4 5/16 x 2 7/16 x 7 7/8 | 50# | 400 | 1/400 | 200 | 20x10 | 6.4 | 11.25 x 8 x 4 | 0.21 | 48 x 38.5 x 45 |
| 70203 | 079594702034 | 3# | 4 3/4 x 2 15/16 x 8 3/16 | 50# | 400 | 1/400 | 144 | 16x9 | 8.0 | 12.5 x 9 x 4.75 | 0.31 | 46.5 x 39.5 x 47.75 |
| 70204 | 079594702041 | 4# | 5 x 3 1/8 x 9 3/4 | 50# | 400 | 1/400 | 112 | 14x8 | 9.4 | 12.75 x 10 x 5 | 0.37 | 45.5 x 40 x 45 |
| 70205 | 079594702058 | 5# | 5 1/4 x 3 7/16 x 10 15/16 | 50# | 400 | 1/400 | 88 | 11x8 | 12.1 | 13.5 x 11 x 5.5 | 0.47 | 44 x 38 x 49 |
| 70206 | 079594702065 | 6# | 6 x 3 5/8 x 11 1/16 | 50# | 400 | 1/400 | 70 | 10x7 | 12.4 | 15 x 11.25 x 6.25 | 0.61 | 45 x 37.5 x 48.75 |
| 70208 | 079594702089 | 8# | 6 1/8 x 4 1/8 x 12 7/16 | 50# | 400 | 1/400 | 63 | 9x7 | 14.8 | 14.5 x 13 x 6.25 | 0.68 | 43.5 x 40.5 x 48.75 |
| 70210 | 079594702102 | 10# | 6 5/16 x 4 3/16 x 13 3/8 | 50# | 400 | 1/400 | 54 | 9x6 | 17.7 | 14.5 x 13.75 x 6.25 | 0.75 | 43.5 x 42 x 44 |
| 70212 | 079594702126 | 12# | 7 1/16 x 4 1/2 x 13 3/4 | 50# | 400 | 1/400 | 54 | 9x6 | 18.8 | 14.5 x 14 x 7.25 | 0.85 | 43.5 x 42.5 x 48.5 |
| 70216 | 079594702164 | 16# | 7 3/4 x 4 13/16 x 16 | 50# | 400 | 1/400 | 45 | 9x5 | 26.5 | 16.25 x 13.5 x 8 | 1.02 | 48.75 x 43.25 x 45 |
| 70220 | 079594702201 | 20# | 8 1/4 x 5 5/16 x 16 1/8 | 50# | 400 | 1/400 | 45 | 9x5 | 26.6 | 16.25 x 13.5 x 8.5 | 1.08 | 48.75 x 43.25 x 47.5 |
| 70221 | 079594702218 | 20# SH | 8 1/4 x 5 5/16 x 13 3/8 | 50# | 400 | 1/400 | 45 | 9x5 | 24.1 | 14 x 13.5 x 8.5 | 0.93 | 42 x 41 x 47.5 |
| 70223 | 079594702232 | 25# | 8 1/4 x 5 1/4 x 18 | 50# | 400 | 1/400 | 40 | 8x5 | 28.2 | 18.5 x 13.5 x 8.5 | 1.23 | 50.5 x 40.5 x 47.5 |
| 70224 | 079594702249 | 25# SH | 8 1/4 x 6 1/8 x 15 7/8 | 50# | 400 | 1/400 | 45 | 9x5 | 26.7 | 15.5 x 13.5 x 8.5 | 1.03 | 46.5 x 42.5 x 47.5 |

SOS Bags



Custom printing available



Bulwark SOS Bags

Kraft Virgin Paper

Performance Features

- Extra heavy-duty virgin paper
- Perfect for take-out and grocery applications
- Resists humidity
- 100% recyclable

| Item# | UPC | Bag Size | Dimensions | Basis Weight | Bale Pack | Pack Config. | Bales/Pallet | Ti/Hi | Bale Weight (lbs.) | Bale Dimensions L x W x H | Cubic | Load Dimensions |
|-------|--------------|----------|---------------------------|--------------|-----------|--------------|--------------|-------|--------------------|---------------------------|-------|---------------------|
| 71002 | 079594710022 | 2# | 4 5/16 x 2 7/16 x 7 7/8 | 52# | 400 | 1/400 | 200 | 20x10 | 6.4 | 11.25 x 8 x 4 | 0.21 | 48 x 38.5 x 45 |
| 71003 | 079594710039 | 3# | 4 3/4 x 2 15/16 x 8 9/16 | 52# | 400 | 1/400 | 144 | 16x9 | 8.0 | 12.5 x 9 x 4.75 | 0.31 | 46.5 x 39.5 x 47.75 |
| 71004 | 079594710046 | 4# | 5 x 3 1/8 x 9 3/4 | 52# | 400 | 1/400 | 112 | 14x8 | 9.4 | 12.75 x 10 x 5 | 0.37 | 45.5 x 40 x 45 |
| 71005 | 079594710053 | 5# | 5 1/4 x 3 7/16 x 10 15/16 | 52# | 400 | 1/400 | 88 | 11x8 | 12.1 | 13.5 x 11 x 5.5 | 0.47 | 44 x 38 x 49 |
| 71006 | 079594710060 | 6# | 6 x 3 5/8 x 11 1/16 | 52# | 400 | 1/400 | 70 | 10x7 | 12.4 | 15 x 11.25 x 6.25 | 0.61 | 45 x 37.5 x 48.75 |
| 71008 | 079594710084 | 8# | 6 1/8 x 4 1/8 x 12 7/16 | 57# | 400 | 1/400 | 63 | 9x7 | 15.2 | 15 x 13 x 6.25 | 0.71 | 45 x 41 x 48.75 |
| 71010 | 079594710107 | 10# | 6 5/16 x 4 3/16 x 13 3/8 | 57# | 400 | 1/400 | 54 | 9x6 | 17.3 | 15.25 x 13.5 x 6.5 | 0.77 | 45.75 x 42.25 x 44 |
| 71012 | 079594710121 | 12# | 7 1/16 x 4 1/2 x 13 3/4 | 57# | 400 | 1/400 | 54 | 9x6 | 21.3 | 16 x 14 x 7.25 | 0.94 | 48 x 44 x 48.5 |
| 71016 | 079594710169 | 16# | 7 3/4 x 4 13/16 x 16 | 57# | 400 | 1/400 | 30 | 6x5 | 26.4 | 16.5 x 16 x 8 | 1.22 | 48.5 x 33 x 45 |
| 71020 | 079594710206 | 20# | 8 1/4 x 5 5/16 x 16 1/8 | 57# | 400 | 1/400 | 30 | 6x5 | 28.8 | 16.25 x 16 x 8.5 | 1.28 | 48.5 x 32.5 x 47.5 |
| 71021 | 079594710213 | 20# SH | 8 1/4 x 5 5/16 x 13 3/8 | 57# | 400 | 1/400 | 45 | 9x5 | 28.5 | 16 x 14 x 8.5 | 1.10 | 48 x 44 x 47.5 |
| 71025 | 079594710251 | 25# | 8 1/4 x 5 1/4 x 18 | 57# | 400 | 1/400 | 30 | 6x5 | 31.2 | 18.5 x 16 x 8.5 | 1.46 | 50.5 x 37 x 47.5 |
| 71026 | 079594710268 | 25# SH | 8 1/4 x 6 1/8 x 15 7/8 | 57# | 400 | 1/400 | 30 | 6x5 | 29.2 | 16 x 15.5 x 8.5 | 1.22 | 47 x 32 x 47.5 |

Dubl Life® 1/6, 1/7 & 1/8 BBL Sacks

100% Recycled Kraft

Performance Features

- Made from 100% Recycled Paper
- Bags are FSC chain of custody certified
- Printing Capabilities: 1/6 BBL - Up to 4 colors on 4 sides; 1/8 BBL - Up to 3 colors on 4 sides; 1/7 BBL - Up to 3 colors on 2 sides



Available in stock or custom printing

| Item# | UPC | Description | Dimensions | Basis Weight | Bale Pack | Pack Config. | Bales/Pallet | Ti/Hi | Bale Weight (lbs.) | Bale Dimensions L x W x H | Cubic | Load Dimensions |
|-------|--------------|--|-------------------------|--------------|-----------|--------------|--------------|---------|--------------------|---------------------------|-------|------------------|
| 18061 | 079594180610 | 1/6 BBL | 12 x 7 x 17 | 57# | 500 | 1/500 | 20 | 6+8+6 | 55 | 18 x 18 x 12 | 59.38 | 54 x 40 x 47.5 |
| 18062 | 079594180627 | 1/6 BBL | 12 x 7 x 17 | 60# | 500 | 1/500 | 20 | 6+8+6 | 53.78 | 17.5 x 20 x 12 | 57.12 | 52.5 x 40 x 47 |
| 18063 | 079594180634 | 1/6 BBL | 12 x 7 x 17 | 66# | 500 | 1/500 | 20 | 6+8+6 | 62 | 18 x 21 x 12.5 | 63.66 | 54 x 42 x 48.5 |
| 13607 | 079594136075 | 1/6 BBL | 12 x 7 x 17 | 70# | 300 | 1/300 | 20 | 10x2 | 39.66 | 17.5 x 15.5 x 12 | 58.55 | 52 x 41 x 47 |
| 18067 | 079594180672 | 1/7 BBL | 12 x 7 x 14 | 57# | 500 | 1/500 | 18 | 6x3 | 45.8 | 14.5 x 18 x 12 | 59.38 | 54 x 40 x 47.5 |
| 18068 | 079594180689 | 1/7 BBL | 12 x 7 x 14 | 60# | 500 | 1/500 | 18 | 6x3 | 45.8 | 14.5 x 18 x 12 | 59.38 | 54 x 40 x 47.5 |
| 18069 | 079594180696 | 1/7 BBL | 12 x 7 x 14 | 66# | 500 | 1/500 | 18 | 6x3 | 45.8 | 14.5 x 18 x 12 | 59.38 | 54 x 40 x 47.5 |
| 13608 | 079594136082 | 1/8 BBL | 9 3/4 x 6 1/4 x 16 3/8 | 70# | 400 | 1/400 | 20 | 10x2 | 42.1 | 20 x 16.5 x 9.8 | 59.29 | 51 x 41 x 49 |
| 13609 | 079594136099 | 1/8 BBL | 10 1/8 x 6 3/4 x 14 3/8 | 70# | 400 | 1/400 | 20 | 10x2 | 36.13 | 19 x 10.5 x 15 | 67.27 | 51 x 41 x 49 |
| 18073 | 079594180733 | 1/8 BBL | 10 1/8 x 6 3/4 x 14 3/8 | 52# | 500 | 1/500 | 30 | 10x3 | 41 | 16 x 18 x 11 | 67.27 | 52.5 x 41 x 54 |
| 18074 | 079594180740 | 1/8 BBL | 9 3/4 x 6 1/4 x 16 3/8 | 52# | 500 | 1/500 | 26 | 10+10+6 | 40 | 16.5 x 17.5 x 10.5 | 54.45 | 48.5 x 40 x 48.5 |
| 18075 | 079594180757 | 1/8 BBL | 10 1/8 x 6 3/4 x 14 3/8 | 57# | 500 | 1/500 | 30 | 10x3 | 45 | 16 x 17 x 11 | 66.01 | 52 x 41 x 53.5 |
| 18076 | 079594180764 | 1/8 BBL | 9 3/4 x 6 1/4 x 16 3/8 | 57# | 500 | 1/500 | 26 | 10+10+6 | 45 | 16.5 x 20 x 10.5 | 59.29 | 51 x 41 x 49 |
| 41265 | 079594412650 | 1/6 EZ-K UP Thank You | 13 x 7 x 17 | 70# | 300 | 1/300 | 18 | 9x2 | 44.12 | 19 x 19 x 12 | 51.36 | 48 x 43 x 43 |
| 45003 | 079594450034 | 1/6 EZ-K UP Printed Sustainable Future | 12 x 7 x 17 | 70# | 300 | 1/300 | 18 | 9x2 | 47 | 19 x 19 x 12 | 51.36 | 48 x 43 x 43 |
| 13606 | 079594136068 | 1/6 EZ-K UP | 12 x 7 x 17 | 70# | 300 | 1/300 | 18 | 9x2 | 47 | 19 x 19 x 12 | 51.36 | 48 x 43 x 43 |
| 18828 | 079594188289 | 1/7 EZ-K DN Printed Sustainable Future | 12 x 7 x 14 | 70# | 300 | 1/300 | 24 | 8x3 | 37 | 15 x 20 x 12 | 54.56 | 48.5 x 40.5 x 48 |
| 18072 | 079594180726 | 1/7 EZ-K DN | 12 x 7 x 14 | 70# | 300 | 1/300 | 24 | 8x3 | 37 | 15 x 20 x 12 | 54.56 | 48.5 x 40.5 x 48 |

Sacks



1/6, 1/7 & 1/8 BBL Sacks

Kraft and White Virgin Paper

Performance Features

- 100% recyclable
- Available with or without sturdy handles
- Made from renewable resources
- Printing Capabilities:
1/6 BBL - Up to 4 colors on 4 sides;
1/8 BBL - Up to 3 colors on 4 sides;
1/7 BBL - Up to 3 colors on 2 sides



Custom printing available

| Item # | UPC | Description | Pack Size | Paper | Bag Dim L x W x H | Basis Wt | Bale Wt | Bale/Carton L x W x H | Cube | BPP | Ti/Hi |
|--------|--------------|-------------|-----------|-------|-------------------------|----------|---------|--------------------------|------|-----|--------|
| 80075 | 079594800754 | 1/6 BBL | 500 | Kraft | 12 x 7 x 17 | 52# | 50 | 18 x 19 x 12 | 2.40 | 20 | 6+8+6 |
| 80086 | 079594800860 | 1/6 BBL | 500 | White | 12 x 7 x 17 | 52# | 50 | 18 x 19 x 12 | 2.40 | 20 | 6+8+6 |
| 80076 | 079594800761 | 1/6 BBL | 500 | Kraft | 12 x 7 x 17 | 57# | 55 | 18 x 18 x 12 | 2.27 | 20 | 6+8+6 |
| 80077 | 079594800778 | 1/6 BBL | 500 | Kraft | 12 x 7 x 17 | 60# | 54 | 17 1/2 x 20 x 12 | 2.53 | 20 | 6+8+6 |
| 80088 | 079594800884 | 1/6 BBL | 500 | White | 12 x 7 x 17 | 60# | 54 | 17 1/2 x 20 x 12 | 2.53 | 20 | 6+8+6 |
| 80078 | 079594800785 | 1/6 BBL | 500 | Kraft | 12 x 7 x 17 | 66# | 62 | 18 x 21 x 12 1/2 | 2.65 | 20 | 6+8+6 |
| 80079 | 079594800792 | 1/6 BBL | 500 | Kraft | 12 x 7 x 17 | 70# | 63 | 17 1/2 x 20 1/2 x 12 | 2.59 | 20 | 6+8+6 |
| 81233 | 079594812337 | 1/6 BBL | 400 | Kraft | 12 x 7 x 17 | 57# | 44 | 18 x 16 x 12 | 2.65 | 20 | 6+8+6 |
| 81008 | 079594810081 | 1/6 BBL | 400 | Kraft | 12 x 7 x 17 | 66# | 47 | 17 1/2 x 19 x 12 | 2.59 | 20 | 6+8+6 |
| 81068 | 079594810685 | 1/6 BBL | 400 | Kraft | 12 x 7 x 17 | 70# | 51 | 18 x 20 x 12 | 2.53 | 20 | 6+8+6 |
| 80080 | 079594800808 | 1/6 BBL | 400 | Kraft | 12 x 7 x 17 | 76# | 56 | 17 1/2 x 19 1/2 x 12 | 2.26 | 20 | 6+8+6 |
| 80081 | 079594800815 | 1/6 BBL | 400 | Kraft | 12 x 7 x 17 | 80# | 56 | 18 x 20 x 12 | 2.53 | 20 | 6+8+6 |
| 80091 | 079594800914 | 1/6 BBL | 400 | Kraft | 12 x 7 x 17 | 40# | 57 | 18 x 23 x 12 1/4 | 2.81 | 16 | 6+4+6 |
| 84439 | 079594844390 | 1/7 BBL | 500 | Kraft | 12 x 7 x 14 | 52# | 40 | 14 1/2 x 16 x 12 | 1.81 | 18 | 6/3 |
| 81267 | 079594812672 | 1/7 BBL | 500 | Kraft | 12 x 7 x 14 | 57# | 46 | 14 1/2 x 18 x 12 | 1.81 | 18 | 6/3 |
| 81266 | 079594812665 | 1/7 BBL | 500 | Kraft | 12 x 7 x 14 | 60# | 46 | 14 1/2 x 18 1/2 x 12 | 1.81 | 18 | 6/3 |
| 81265 | 079594812658 | 1/7 BBL | 500 | Kraft | 12 x 7 x 14 | 66# | 52 | 14 1/2 x 19 1/2 x 12 | 1.76 | 18 | 6/3 |
| 81263 | 079594812634 | 1/7 BBL | 400 | Kraft | 12 x 7 x 14 | 76# | 47 | 14 1/2 x 20 x 12 | 1.91 | 18 | 6/3 |
| 81186 | 079594811866 | 1/8 BBL | 500 | Kraft | 9 3/4 x 6 1/4 x 16 3/8 | 52# | 38 | 16 1/2 x 17 1/2 x 10 1/2 | 1.75 | 26 | 0+10+6 |
| 80082 | 079594800822 | 1/8 BBL | 500 | Kraft | 10 1/8 x 6 3/4 x 14 3/8 | 52# | 36 | 16 x 18 x 11 | 1.83 | 30 | 10/3 |
| 80090 | 079594800907 | 1/8 BBL | 500 | White | 10 1/8 x 6 3/4 x 14 3/8 | 52# | 36 | 16 x 18 x 11 | 1.83 | 30 | 10/3 |
| 81187 | 079594811873 | 1/8 BBL | 500 | Kraft | 9 3/4 x 6 1/4 x 16 3/8 | 57# | 46 | 16 1/2 x 20 x 10 1/2 | 2.01 | 26 | 0+10+6 |
| 80083 | 079594800839 | 1/8 BBL | 500 | Kraft | 10 1/8 x 6 3/4 x 14 3/8 | 57# | 41 | 16 x 17 x 11 | 1.73 | 30 | 10/3 |
| 88191 | 079594881913 | 1/7 EZ-K DN | 300 | Kraft | 12 x 7 x 14 | 70# | 37 | 15 x 20 x 12 | 1.7 | 24 | 8x3 |
| 88855 | 079594888554 | 1/6 EZ-K UP | 400 | White | 12 x 7 x 17 | 66# | 57 | 18 x 23 x 12 | 2.87 | 16 | 8x2 |
| 88885 | 079594888851 | 1/6 EZ-K UP | 300 | Kraft | 12 x 7 x 17 | 70# | 47 | 19 x 19 x 12 | 2.5 | 18 | 9x2 |

Sacks



Custom printing available

1/4 BBL & Satchel Bottom Sacks

Kraft Virgin Paper

Performance Features

- Printing Capabilities: Up to 2 colors on 4 sides
- Minimum Shipment: 200 bales pre paid
- Lead-Time: Stock item 2 weeks; custom prints 4-6 weeks after final art approval
- Always recyclable and compostable

| Item # | UPC | Description | Pack Size | Paper | Bag Dim L x W x H | Basis Wt | Bale Wt | Bale/Carton L x W x H | Cube | BPP | Ti/Hi |
|--------|--------------|--------------------|-----------|-------|-------------------|----------|---------|-----------------------|-------|-----|-------|
| 80070 | 079594800709 | 1/4 BBL SOS | 250 | Kraft | 12 x 7 x 23 1/4 | 60# | 37 | 23.8 x 13.3 x 12.6 | 2.316 | 18 | 6x3 |
| 80071 | 079594800716 | 1/4 BBL SOS | 250 | Kraft | 12 x 7 x 23 1/4 | 66# | 40 | 23.8 x 13.3 x 12.6 | 2.316 | 18 | 6x3 |
| 84045 | 079594840453 | 1/4 BBL SOS | 250 | Kraft | 12 x 7 x 21 3/4 | 66# | 40 | 23.8 x 13.3 x 12.6 | 2.316 | 18 | 6x3 |
| 80094 | 079594800945 | 1/4 Satchel Bottom | 250 | Kraft | 17 x 6 x 28 1/2 | 52# | 34 | 32 x 20 x 7 | 2.593 | 18 | 3x6 |
| 80095 | 079594800952 | 1/4 Satchel Bottom | 250 | Kraft | 17 x 6 x 28 1/2 | 60# | 41 | 32 x 20 x 7.5 | 2.778 | 18 | 3x6 |
| 80096 | 079594800969 | 1/4 Satchel Bottom | 250 | Kraft | 17 x 6 x 28 1/2 | 66# | 42 | 32 x 20 x 8 | 2.963 | 18 | 3x6 |

Die Cut Handle Bags

100% Recycled Kraft, Kraft and White Virgin Paper

Performance Features

- Dubl Life® bag made from 100% Recycled Paper
- Dubl Life bag is FSC chain of custody certified
- Large rectangular flat bottom creates stable carrier for platters and clam shell packaging
- Die cut handles create easy-carrying feature that supports stability and convenience
- 3/4 die cut handle creates a built-in locking system that allows the bag to be easily picked up and carried.

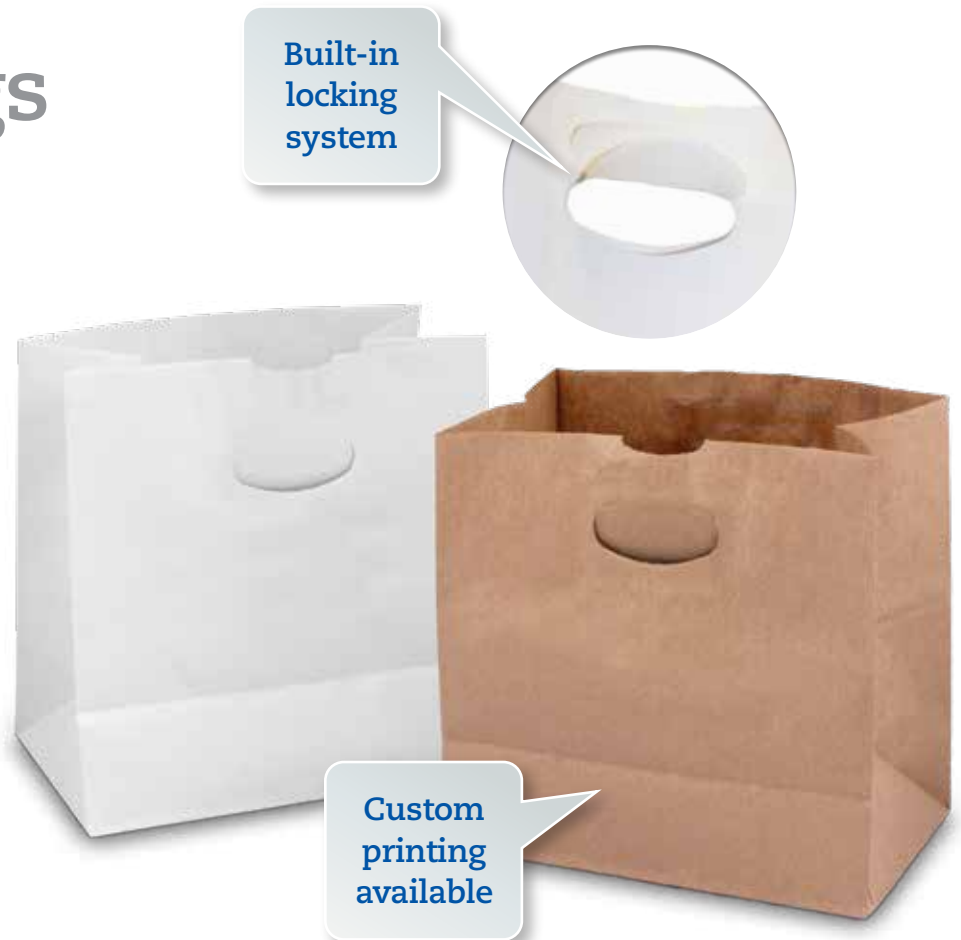

| Item# | UPC | Bag Size / Description | Dimensions | Basis Weight | Bale Pack | Pack Config. | Bales/Pallet | Ti/Hi | Bale Weight (lbs.) | Bale Dimensions L x W x H | Cubic | Load Dimensions |
|-------|--------------|----------------------------|-------------|--------------|-----------|--------------|--------------|-------|--------------------|---------------------------|-------|-----------------|
| 18077 | 079594180771 | Dubl Life ¾ Die Cut Handle | 11 x 6 x 11 | 40 | 500 | 1/500 | 36 | 9x4 | 27.83 | 16 x 13 x 11.5 | 1.38 | 48 x 41 x 45 |
| 83862 | 079594838627 | ¾ Die Cut Handle White | 11 x 6 x 11 | 40 | 500 | 1/500 | 36 | 9x4 | 28 | 17.5 x 11.5 x 10.5 | 1.38 | 48 x 41 x 45 |
| 84245 | 079594842457 | ¾ Die Cut Handle Kraft | 11 x 6 x 11 | 40 | 500 | 1/500 | 36 | 9x4 | 28 | 17.5 x 11.5 x 10.5 | 1.38 | 48 x 41 x 45 |

* plastic patch on die cut handle must be removed before recycling/composting

Liquor Bags

100% Recycled Kraft and Kraft Virgin Paper

Performance Features

- Dubl Life bag made from 100% Recycled Paper
- Dubl Life bag is FSC chain of custody certified
- Pinch bottom Liquor Bags accommodate all of your libation needs in four convenient sizes

Custom printing available



| Item# | UPC | Bag Size / Description | Dimensions | Basis Weight | Bale Pack | Pack Config. | Bales/Pallet | Ti/Hi | Bale Weight (lbs.) | Bale Dimensions L x W x H | Cubic | Load Dimensions |
|-------|--------------|------------------------|------------------------|--------------|-----------|--------------|--------------|-------|--------------------|---------------------------|-------|-----------------|
| 40028 | 079594400282 | 1/2 Pint | 4 x 1 1/4 x 10 | 35# | 2M | 4/500 | 28 | 7x4 | 22 | 12 x 17 x 8.75 | 1.03 | 49 x 39 x 47 |
| 19208 | 079594192088 | Dubl Life® Pint | 3 3/4 x 2 1/4 x 11 1/2 | 35# | 500 | 1/500 | 150 | 15x10 | 6.9 | 13.5 x 8.5 x 4.25 | 0.28 | 42 x 42 x 45 |
| 40032 | 079594400329 | Pint | 3 3/4 x 2 1/4 x 11 1/2 | 35# | 500 | 1/500 | 150 | 15x10 | 6.9 | 13.5 x 8.5 x 4.25 | 0.28 | 42 x 42 x 49 |
| 40030 | 079594400305 | Pint | 3 3/4 x 2 1/4 x 11 1/2 | 35# | 2M | 4/500 | 45 | 9x5 | 27.1 | 13.5 x 17 x 8.5 | 1.13 | 49 x 42 x 45 |
| 19209 | 079594192095 | Dubl Life Quart | 4 1/4 x 2 1/2 x 16 | 35# | 500 | 1/500 | 80 | 10x8 | 9.9 | 17 x 8.5 x 4.5 | 0.38 | 42 x 35 x 40.5 |
| 40036 | 079594400367 | Quart | 4 1/4 x 2 1/2 x 16 | 35# | 500 | 1/500 | 80 | 10x8 | 9.9 | 17 x 8.5 x 4.5 | 0.38 | 42 x 35 x 46 |
| 40034 | 079594400343 | Quart | 4 1/4 x 2 1/2 x 16 | 35# | 1M | 2/500 | 40 | 10x4 | 20.6 | 17 x 8.5 x 9 | 0.75 | 42 x 35 x 41.5 |
| 13605 | 079594136051 | Dubl Life Liter | 5 x 3 x 16 | 50# | 500 | 1/500 | 48 | 8x6 | 19.75 | 17.75 x 14 x 5.25 | 0.75 | 45 x 37 x 46.5 |

Merchandise Bags



Merchandise Bags

100% Recycled Kraft,
Kraft and White Virgin Paper

Performance Features

- Dubl Life® bag is made from 100% recycled paper
- Wide variety of weights and sizes to fit all your packaging needs
- Versatile Merchandise Bag can be used for anything from greeting cards or socks to pastries

Custom printing
available



| Item# | UPC | Paper | Dimensions | Basis Weight | Bale Pack | Pack Config. | Bales/Pallet | Ti/Hi | Bale Weight (lbs.) | Bale Dimensions L x W x H | Cubic | Load Dimensions |
|-------|--------------|-----------|-----------------|--------------|-----------|--------------|--------------|--------|--------------------|---------------------------|-------|-----------------------|
| 14059 | 079594140591 | Dubl Life | 6 ¼ x 9 ¼ | 30# | 1000 | 3000 | 24 | 12 x 2 | 29 | 12.5 x 11.5 x 21 | 1.67 | 45.5 x 40 x 47 |
| 14927 | 079594149273 | White | 6.25 x 9.25 | 30# | 1000 | 3000 | 24 | 12 x 2 | 29 | 12.32 x 11.32 x 20.64 | 1.67 | 45.28 x 36.96 x 46.78 |
| 14853 | 079594148535 | White | 8.5 x 11 | 30# | 1000 | 2000 | 28 | 7 x 4 | 30 | 20.32 x 13.32 x 9.64 | 1.51 | 46.69 x 40.64 x 43.56 |
| 14899 | 079594148993 | White | 10 x 13 | 30# | 1000 | 1000 | 40 | 10 x 4 | 21 | 15.82 x 11.32 x 11.64 | 1.21 | 47.46 x 38.46 x 52.06 |
| 14872 | 079594148726 | White | 12 x 15 | 30# | 1000 | 1000 | 30 | 10 x 3 | 29 | 18.32 x 9.32 x 13.39 | 1.32 | 46.6 x 36.64 x 46.42 |
| 14906 | 079594149068 | White | 15 x 18 | 30# | 500 | 500 | 30 | 6 x 5 | 21 | 20.82 x 15.82 x 5.64 | 1.08 | 47.46 x 41.64 x 33.2 |
| 14957 | 079594149570 | White | 10 x 2 x 15 | 30# | 500 | 1000 | 24 | 12 x 2 | 28 | 17.32 x 9.07 x 21.14 | 1.92 | 45.37 x 43.71 x 47.28 |
| 14935 | 079594149358 | White | 12 x 3 x 18 | 30# | 500 | 500 | 30 | 6 x 5 | 22 | 21.32 x 13.32 x 8.64 | 1.42 | 42.64 x 39.96 x 48.7 |
| 14889 | 079594148894 | White | 14 x 3 x 21 | 30# | 500 | 500 | 25 | 5 x 5 | 28 | 24.82 x 14.82 x 8.14 | 1.73 | 49.64 x 39.64 x 46.2 |
| 14881 | 079594148818 | White | 17 x 4 x 24 | 30# | 500 | 500 | 20 | 4 x 5 | 39 | 27.32 x 19.32 x 8.64 | 2.64 | 46.64 x 46.64 x 48.7 |
| 14975 | 079594149754 | Kraft | 5 x 7.5 | 30# | 1000 | 4000 | 32 | 8 x 4 | 26 | 22.32 x 11.32 x 11.14 | 1.63 | 45.28 x 44.64 x 50.06 |
| 14926 | 079594149266 | Kraft | 6.25 x 9.25 | 30# | 1000 | 3000 | 24 | 12 x 2 | 29 | 12.32 x 11.32 x 20.64 | 1.67 | 45.28 x 36.96 x 46.78 |
| 14970 | 079594149709 | Kraft | 7.5 x 10.5 | 30# | 1000 | 2000 | 25 | 5 x 5 | 26 | 22.32 x 15.32 x 8.64 | 1.71 | 45.96 x 37.64 x 48.7 |
| 14852 | 079594148528 | Kraft | 8.5 x 11 | 30# | 1000 | 2000 | 28 | 7 x 4 | 30 | 20.32 x 13.32 x 9.64 | 1.51 | 46.96 x 40.64 x 43.56 |
| 14898 | 079594148986 | Kraft | 10 x 13 | 30# | 1000 | 1000 | 40 | 10 x 4 | 21 | 15.82 x 11.32 x 11.64 | 1.21 | 47.46 x 38.46 x 52.06 |
| 14871 | 079594148719 | Kraft | 12 x 15 | 30# | 1000 | 1000 | 30 | 10 x 3 | 29 | 18.32 x 9.32 x 13.64 | 1.35 | 46.6 x 36.64 x 46.42 |
| 14913 | 079594149136 | Kraft | 13 x 15 | 30# | 500 | 1000 | 30 | 10 x 3 | 30 | 18.32 x 9.32 x 14.64 | 1.45 | 46.6 x 36.64 x 49.42 |
| 14956 | 079594149563 | Kraft | 10 x 2 x 15 | 30# | 500 | 1000 | 24 | 12 x 2 | 28 | 17.32 x 9.07 x 21.14 | 1.92 | 45.37 x 43.71 x 47.28 |
| 14905 | 079594149051 | Kraft | 15 x 18 | 30# | 500 | 500 | 30 | 6 X 5 | 21 | 20.82 x 15.82 x 5.64 | 1.08 | 47.46 x 41.64 x 33.2 |
| 14934 | 079594149341 | Kraft | 12 x 3 x 18 | 30# | 500 | 500 | 30 | 6 X 5 | 22 | 21.32 x 13.32 x 8.64 | 1.42 | 42.64 x 39.96 x 48.7 |
| 14888 | 079594148887 | Kraft | 14 x 3 x 21 | 30# | 500 | 500 | 25 | 5 X 5 | 28 | 24.82 x 14.82 x 8.14 | 1.73 | 49.64 x 39.64 x 46.2 |
| 14879 | 079594148795 | Kraft | 17 x 4 x 24 | 30# | 500 | 500 | 20 | 4 x 5 | 39 | 27.32 x 19.32 x 8.64 | 2.64 | 46.64 x 46.64 x 48.7 |
| 14966 | 079594149662 | Kraft | 22.5 x 7.5 x 30 | 40# | 125 | 125 | 16 | 2 x 8 | 23 | 34.32 x 23.82 x 4.64 | 2.20 | 47.64 x 34.32 x 42.62 |

Load and Fold™ Shopping Bags

Kraft and White Virgin Paper

Performance Features

- Patent Pending Design
- Single and double fold over options
- Wide opening for easy loading
- Flat bottom keeps items secure and allows bag to stand on its own
- Tamper evident option using a branded label or other adhesive
- Sturdy paper twist handles for ease in carrying
- Available in popular shopping bag sizes



GROCERY



FOODSERVICE

Available in various sizes and substrates, including wet-strength properties to protect against the elements. The Load and Fold™ Bag is perfect for a variety of uses, including home delivery, gift bag, gift registry, and much more.

Custom printing available



E-COMMERCE



RETAIL

Add a tamper evident branded label

| ID | SUPC | Description | Dimensions | Basis Weight | Pack Qty | Ship Wt. | Ti/Hi | Carton Cubic Ft. | Carton Dimensions (L X W X H) |
|-------|---------|-------------|---------------|--------------|----------|----------|-------|------------------|-------------------------------|
| 68533 | 9905597 | Regal | 12 x 9 x 15 ¾ | 65# | 200 | 26.00 | 6 x 3 | 1.38 | 10 ¾ x 13 x 16 |
| 68534 | 9905603 | Bistro | 10 x 6 ¾ x 12 | 60# | 250 | 26.00 | 6 x 4 | 1.38 | 21 x 20 x 10 ½ |

Lawn & Leaf Bags



Lawn & Leaf Bags

Kraft Virgin Paper

Performance Features

- Bag Dimensions: 16" x 12" x 35"
- 30 Gallon Capacity
- Materials & Construction: Kraft – 2 ply
- Inner and Outer Ply: Kraft, wet strength treated
- Adhesives: Non toxic and moisture resistant
- Available plain, custom print, or stock print
- Custom print: up to 4 colors and 1-4 sides



| Item # | UPC# | Description | Stock/ Non-Stock | Bale Dimensions L x W x H | Bale Pack | Bale Weight | Bale Cube | Bales/ Pallet | Pallet Ti/Hi | Pallet Per Truck |
|--------|--------------|---|---------------------|------------------------------|--------------|----------------|--------------|------------------|-----------------|---------------------|
| 13818 | 079594138185 | Plain Lawn & Leaf 50pk 50#/50# Kraft/Wet | Stock | 16 1/2 x 12 1/2 x 13 | 2/25 | 28# | 1.6 | 36 | 9/4 | 40 |
| 21809 | 079594370912 | Tri-Fold Retail Pack 50#/50# Kraft/Wet | Stock | 16 1/2 x 12 1/2 x 14 | 12/5 | 34# | 1.7 | 27 | 9/3 | 42 |
| 22453 | 079594370899 | Tri-Fold Carton Pack 50#/50# Kraft/Wet | Stock | 17 1/2 x 13 1/2 x 15 | 12/5 | 36# | 2.0 | 24 | 8/3 | 44 |
| 21844 | 079594382014 | Tri-Fold Bilingual Carton 50#/50# Kraft/Wet | Non-Stock | 17 1/2 x 13 1/2 x 15 | 12/5 | 36# | 2.0 | 24 | 8/3 | 44 |
| 37090 | 079594370905 | Tri-Fold Retail Display 50#/50# Kraft/Wet | Non-Stock | 17 1/2 x 13 1/2 x 15 | 12/5 | 36# | 2.0 | 27 | 8/3 | 44 |
| 75311 | 079594753111 | Lawn & Leaf Bulk Pack Stock Print 50#/50# Kraft/Wet | Non-Stock | 37 x 15 3/4 x 4 1/2 | 50 | 28# | 1.5 | 33 | 3/11 | 44 |
| 37123 | 079594371230 | Tri-Fold Maximizer Pallet 50#/50# Kraft/Wet | Non-Stock | 40 x 52 x 48 | 80/25 | 1133# | 48.88 | 80 | 8/10 | 36 |
| 22507 | 079594225076 | Maximum Traffic Display 50#/50# Kraft/Wet | Non-Stock | 39 x 45 x 44 | 400/5 | 1148# | 49.69 | 400 | 8/50 | 36 |

Dubl Life® Shopping Bags

Performance Features

- Made from 100% Recycled Paper
- Bags are FSC chain of custody certified
- Assortment of bag footprints are perfect for a variety of foodservice containers and retail needs
- Features strong and comfortable paper twist handles ensuring safe transport

Custom
printing
available



| Item # | UPC# | Bag Name | Dimensions | Basis Weight | Pack Qty | Ship Wt. | Ti/Hi | Carton Cubic Ft. | Carton Dimensions (L x W x H) |
|--------|--------------|-------------|------------------|--------------|----------|----------|----------------|------------------|-------------------------------|
| 87093 | 079594870931 | Gem | 5 ¼ x 3 ¼ x 8 ¾ | 60# | 250 | 14.20 | 8 x 3 | 1.55 | 18 x 11 x 13 ½ |
| 75079 | 079594750790 | Vino | 5 ¼ x 3 ¼ x 13 ½ | 65# | 250 | 17.21 | 8 x 3 | 1.55 | 18 x 11 x 13 ½ |
| 87097 | 079594870979 | Tempo | 8 x 4 ½ x 10 ¼ | 60# | 250 | 21.75 | 6 x 4 | 2.61 | 17 x 18 ¾ x 14 ½ |
| 87124 | 079594871242 | Missy | 10 x 5 x 13 | 60# | 250 | 26.00 | 6 x 4 | 3.14 | 21 ¾ x 18 ½ x 13 ½ |
| 87098 | 079594870986 | Kary | 9 x 5 ¾ x 13 ½ | 60# | 250 | 27.00 | 4x4 4x3* | 2.67 | 21 ¼ x 20 ¼ x 11 |
| 87490 | 079594874908 | Bistro | 10 x 6 ¾ x 12 | 60# | 250 | 27.00 | 6 x 4 | 2.55 | 21 x 20 x 10 ½ |
| 87129 | 079594871297 | Tote | 16 x 6 x 12 | 65# | 250 | 36.05 | 5 x 3 | 3.41 | 23 ¾ x 16 ¼ x 15 ¼ |
| 87523 | 079594875233 | Jr. Mart | 13 x 7 x 13 | 65# | 250 | 33.00 | 6 x 3 | 2.94 | 20 ½ x 15 ½ x 16 |
| 87127 | 079594871273 | Traveler | 13 x 6 x 15 ¾ | 60# | 250 | 35.00 | 6 x 3 6 x 2* | 3.06 | 23 ½ x 14 ¾ x 15 ¼ |
| 87131 | 079594871310 | Debonair | 16 x 6 x 15 ¾ | 65# | 200 | 41.00 | 6 x 3 | 2.83 | 20 x 16 ¾ x 16 |
| 87128 | 079594871280 | Mart | 13 x 7 x 17 | 65# | 250 | 31.00 | 6 x 3 | 3.2 | 23 ½ x 15 x 16 |
| 87133 | 079594871334 | Royal | 14 x 8 x 14 ¾ | 65# | 200 | 35.00 | 6 x 3 | 2.98 | 21 ½ x 15 ½ x 15 ½ |
| 87415 | 079594874151 | Regal | 12 x 9 x 15 ¾ | 65# | 200 | 33.00 | 7 x 3 | 2.49 | 20 ¾ x 13 x 16 |
| 87130 | 079594871303 | Towner | 16 x 6 x 19 ¼ | 65# | 200 | 39.00 | 5 x 3 | 3.57 | 23 ¾ x 16 ¼ x 16 |
| 87145 | 079594871457 | Super Royal | 14 x 10 x 15 ¾ | 70# | 200 | 41.53 | 6 x 3 | 3.2 | 23 ¾ x 16 ¼ x 16 ½ |
| 87148 | 079594871488 | Cargo | 18 x 7 x 18 ¾ | 70# | 200 | 36.00 | 4 x 3 | 3.89 | 23 ½ x 18 ¾ x 15 ¼ |

*Ti/Hi for Rio Bravo, MX – Ti/Hi may vary by manufacturing location. Please check with your Customer Service Representative for more details.

Shopping Bags



Shopping Bags

Kraft and White Virgin Paper

Performance Features

- Bags range from the standard basis weight of 60-65# for the small and medium sizes to a heavy duty 70-80# weight for our larger bags
- Available in your choice of kraft or white
- Sturdy yet comfortable paper-twist handle



White Virgin Paper

| Item # | UPC# | Description | Dimensions | Basis Weight | Pack Qty | Ship Wt. | Ti/Hi | Carton Cubic Ft. | Carton Dimensions (L x W x H) |
|--------|--------------|-------------|------------------------|--------------|----------|----------|----------------|------------------|-------------------------------|
| 86841 | 079594868419 | Gem | 5 1/4 x 3 1/4 x 8 3/8 | 60# | 250 | 14.20 | 8 x 3 | 1.55 | 18 x 11 x 13 1/2 |
| 81608 | 079594816083 | Vino | 5 1/4 x 3 1/4 x 13 1/8 | 65# | 250 | 17.21 | 8 x 3 | 1.55 | 18 x 11 x 13 1/2 |
| 84598 | 079594845984 | Tempo | 8 x 4 1/2 x 10 1/4 | 60# | 250 | 21.75 | 6 x 4 | 2.61 | 17 x 18 3/4 x 14 1/8 |
| 84641 | 079594846417 | Missy | 10 x 5 x 13 | 60# | 250 | 26.00 | 6 x 4 | 3.14 | 21 3/4 x 18 1/2 x 13 1/2 |
| 84625 | 079594846257 | Kary | 9 x 5 3/4 x 13 1/2 | 60# | 250 | 27.00 | 4x4 4x3* | 2.67 | 21 1/4 x 20 1/4 x 11 |
| 88206 | 079594882064 | Bistro | 10 x 6 3/4 x 12 | 60# | 250 | 27.00 | 6 x 4 | 2.55 | 21 x 20 x 10 1/2 |
| 86785 | 079594867856 | Tote | 16 x 6 x 12 | 65# | 250 | 36.05 | 5 x 3 | 3.41 | 23 3/4 x 16 1/4 x 15 1/4 |
| 87281 | 079594872812 | Jr. Mart | 13 x 7 x 13 | 65# | 250 | 33.00 | 6 x 3 | 2.94 | 20 1/2 x 15 1/2 x 16 |
| 84640 | 079594846400 | Traveler | 13 x 6 x 15 3/4 | 60# | 250 | 35.00 | 6 x 3 6 x 2* | 3.06 | 23 1/2 x 14 3/4 x 15 1/4 |
| 86589 | 079594865890 | Debonair | 16 x 6 x 15 3/4 | 65# | 200 | 41.00 | 6 x 3 | 2.83 | 20 x 16 3/4 x 16 |
| 84642 | 079594846424 | Mart | 13 x 7 x 17 | 65# | 250 | 31.00 | 6 x 3 | 3.2 | 23 1/2 x 15 x 16 |
| 81646 | 079594816465 | Royal | 14 x 8 x 14 5/8 | 65# | 200 | 35.00 | 6 x 3 | 2.98 | 21 1/2 x 15 1/2 x 15 1/2 |
| 87904 | 079594879040 | Regal | 12 x 9 x 15 3/4 | 65# | 200 | 33.00 | 7 x 3 | 2.49 | 20 3/4 x 13 x 16 |
| 86797 | 079594867979 | Towner | 16 x 6 x 19 1/4 | 65# | 200 | 39.00 | 5 x 3 | 3.57 | 23 3/4 x 16 1/4 x 16 |
| 85934 | 079594859349 | Super Royal | 14 x 10 x 15 3/4 | 70# | 200 | 41.53 | 6 x 3 | 3.2 | 23 3/4 x 16 1/4 x 16 1/2 |
| 86787 | 079594867870 | Cargo | 18 x 7 x 18 3/4 | 70# | 200 | 36.00 | 4 x 3 | 3.89 | 23 1/2 x 18 3/4 x 15 1/4 |
| 87942 | 079594879422 | Grandé | 16 x 11 x 18 1/4 | 70# | 200 | 52.80 | 5x3 | 3.51 | 24 x 7 1/4 x 18 3/4 |
| 81289 | 079594812894 | Magnum | 24 x 7 1/4 x 18 3/4 | 80# | 125 | 46.63 | 2x4 | 3.4 | 23 3/4 x 16 1/4 x 15 3/4 |

Ti/Hi for Rio Bravo, MX – Ti/Hi may vary by manufacturing location. Please check with your Customer Service Representative for more details.

Kraft Virgin Paper

| Item # | UPC# | Description | Dimensions | Basis Weight | Pack Qty | Ship Wt. | Ti/Hi | Carton Cubic Ft. | Carton Dimensions (L x W x H) |
|--------|--------------|-------------|---------------------|--------------|----------|----------|-------|------------------|-------------------------------|
| 87941 | 079594879415 | Grandé | 16 x 11 x 18 1/4 | 70# | 200 | 52.80 | 5x3 | 3.51 | 24 x 7 1/4 x 18 3/4 |
| 80722 | 079594807227 | Magnum | 24 x 7 1/4 x 18 3/4 | 80# | 125 | 46.63 | 2x4 | 3.4 | 23 3/4 x 16 1/4 x 15 3/4 |

Sustainability Partnerships

Novolex™ is committed to the protection of the earth through recycling and promotion of



Forest Stewardship Council®

The FSC promotes environmentally appropriate, socially beneficial, and economically viable management of the world's forests. The unique role of the FSC is to bring together people, organizations and businesses to develop consensus-based solutions that promote responsible stewardship of the world's forests. Novolex™ uses the FSC Trademark License FSC C010800 for certified chain of custody products made at all Duro™ Bag, Bagcraft, Deluxe and Burrows Packaging plants.



NC-COC-003922

Rainforest Alliance®

The Rainforest Alliance® is an international nonprofit conservation organization that certifies forestry and agricultural operations, ensuring that they meet rigorous standards for the conservation of natural resources and the rights and welfare of workers and local communities. Working with the Rainforest Alliance®, FSC certification with NEPCon is recognized by the Rainforest Alliance for its Duro Bag, Bagcraft, Deluxe and Burrows Packaging lines of 100% post-consumer recycled bags. The FSC certified paper used for the manufacturing of these products can be tracked through the supply chain including collection from the end user, sorting, paper making, transport, bag making and shipment of the finished product.



Sustainable Forestry Initiative

SFI Inc. promotes **sustainable forest management** in North America and supporting **responsible procurement** globally. SFI Inc. directs all elements of the SFI program including the SFI forest management, fiber sourcing, and chain-of-custody standards, labeling and marketing. SFI certified products provide assurance that the paper used in these products represent a **sound environmental choice** with raw materials from certified forest content or certified sourcing.

Novolex products produced at Duro Bag, Bagcraft, Deluxe and Burrows Packaging are eligible for SFI Certified Sourcing or SFI Chain of Custody logo use. Novolex uses SFI Trademark License Code 01567.



How2Recycle

Novolex is proud to support organizations like the Sustainable Packaging Coalition (SPC) that promote industry wide sustainability initiatives such as How2Recycle the next generation of standardized recycling symbols.

We are proud to work with our customers and the SPC to get the right markings on your products. Learn more at:

How2Recycle.info

Dubl Life® 100% Recycled Paper Packaging



Dubl Life® is a brand of flexible foodservice and carryout packaging made from 100% Recycled Paper. The Dubl Life brand drives awareness of the benefits of recycling and promotes the use of packaging solutions with post consumer material content. Learn how to incorporate the Dubl Life message into your company's branding. Contact your local Novolex sale representative at: novolex.com/contact or learn more at novolex.com/sustainability/dublif

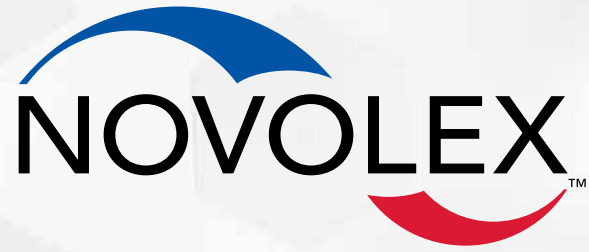

www.novolex.com | © October 2019 Novolex™

D_CA_0031_1019



800-879-3876 (DURO)